

What Is a Gallium Scan?

A Gallium Scan is a diagnostic imaging test that shows a functional image of body tissues. The images show how cells are performing- normally or abnormally- and to what degree.

Gallium, a radioactive isotope compound, is injected into the vein in the arm. This “tracer” is attracted to infections and some tumors in the body. The special nuclear radiology camera picks up images from areas where gallium is absorbed, indicating irregular function of the cells.

How Do I Prepare for a Gallium Scan?

There is no special preparation for a gallium scan. Gallium is not known to cause any side effects or adverse reactions with food or drugs. You should continue taking your prescribed medication.

What Will I Experience During a Gallium Scan?

When you arrive at the nuclear medicine department at the Imaging Center, a technologist will inject the gallium “tracer” into a vein in your arm. You will return to the Center in 1-3 days once the gallium has been absorbed. You can be scanned any time during the 3 days following your tracer injection.

When you return, you will lie on the exam table positioned between a set of cameras. The cameras will be very close to your body. If you are claustrophobic, you should ask your physician for a prescription to help you relax.

The imaging portion of the exam can last 30-90 minutes. It is very important that you remain still while the cameras are moving.

What Happens to the Radioactive Material in My Body?

Most of the radioactive material will be eliminated in your urine and stool. The rest will simply disappear over a short period of time.

When Can I Resume My Daily Activities?

You can resume your normal daily activities immediately after the scan.

Who Interprets the Results? Who Will Tell Me the Results?

A physician who has specialized training in nuclear medicine will interpret the gallium scan. A report will be dictated and sent to your physician. It usually takes 1-2 days for your physician to receive the results. Please contact your physician for your results.

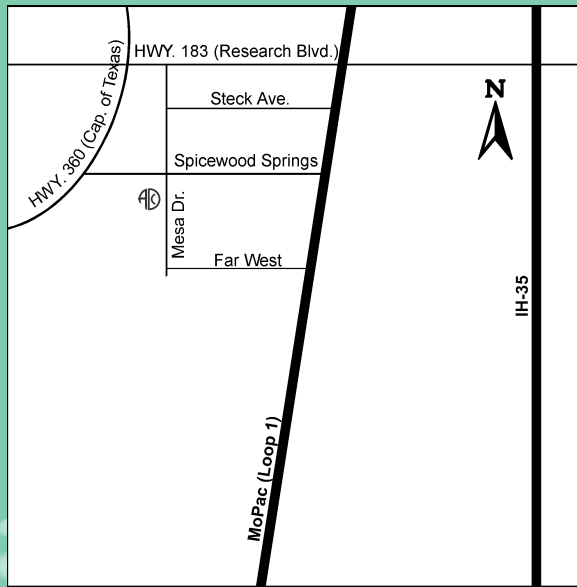

**The Austin Diagnostic Clinic
Imaging Center
8038 Mesa Dr.
Austin, Texas 78731
512-901-8760**

Gallium Scan

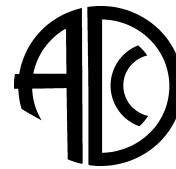

The Austin Diagnostic Clinic
Imaging Center